



Silent Gliss 11092   
Single Channel Timer Unit





## User manual and setting instructions



Intelligent timer remote control

### Features

- Radio control
- Battery operated
- LCD display
- Touch button control
- Timing function with 2 independently programmable time points per day for daily and weekly cycles
- Surface mounted back box with magnetic holder

## Technical Data

Part number	11092
Power Supply	2 x CR2032 (3V) batteries
Power	10mW Max
Radio Frequency	433.92 MHz
Number of channels	1
Operation method	Touch screen
Timer settings	2 Programmable timing points per day

## Screen display and button functions

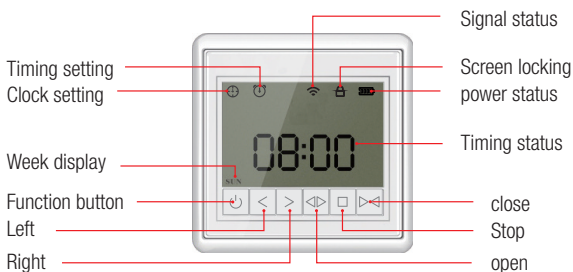

## Rear view

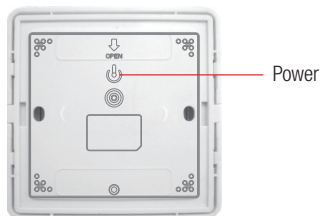

## Installation

Installation with adhesive tape – suitable for glass and smooth tiles



Remove backing tapes

Stick on glass or smooth tile.

Standard wall fixing

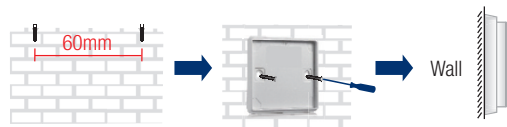

Drill and insert wall plugs

Fix the magnetic holder

Place timer in magnetic holder

## Operating Instructions

Activation

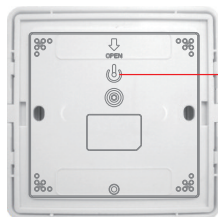

Power  
Press for 1sec. to turn on – display will activate

## Addressing Timer unit to Motor

On Motor

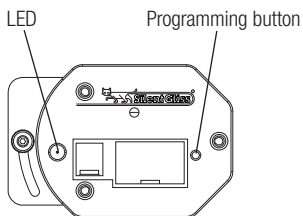

1. Push programming button with a pin for 1 sec
2. LED blinks red
3. Please do following step below within the next 10 sec

On Timer Unit

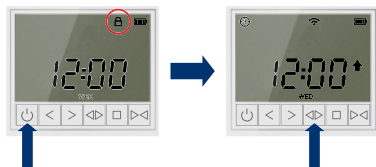

1. Press function button for 3s to enter control window

2. Press open to send signal to motor

If at this point pressing open closes the curtains follow the following steps to change the direction.

1. Press stop on the timer for 5 secs
2. LED on motor flashes red slowly
3. Release stop and re-press within 10 secs
4. LED on motor flashes blue x 3 – direction changed

Please note: During operation the timer locks the screen if there is no further operation within 30 seconds.

## Manual Operation

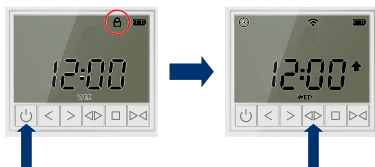

1. Press function button for 3s to enter control window

2. Press open, close, stop to achieve open, close, stop movements manually

## Time and day setting (24 - hour)

For example, if you need to set Thursday 16.35, please follow the steps below



1. Press function button for 3s to enter control window

2. Press function button and hold 3s to enter setting window

3. Press stop function to enter timing setting window



4. Press left/right to change the time/week

5. Press open/close to set time/week, set the time as 16:35, week day as Thursday

6. Press function button and hold for 3s, then back to control window

## Timer setting (2 time points per day – 14 max – Select - A,B,C,E,F,G,H,I,J,L,O,P,S,U).

For example if you want to set time point B (2nd timing point) to open at 8.30 Monday follow the steps below.

1. Enter timing window

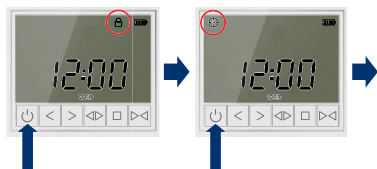

1. Press function button for 3s to enter control window

2. Press function button and hold 3s to enter setting window



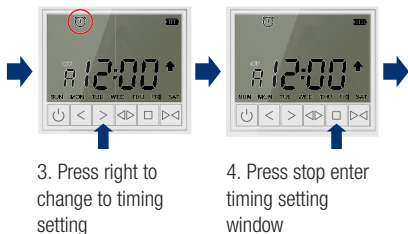

To set time point (time point 2)

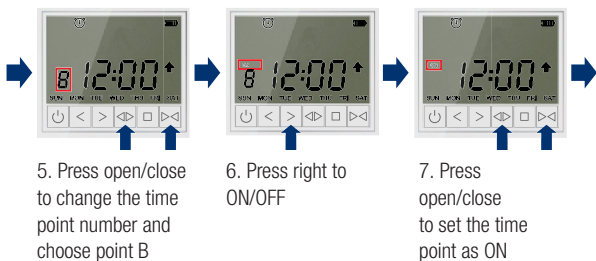

Set the working time (8.30)

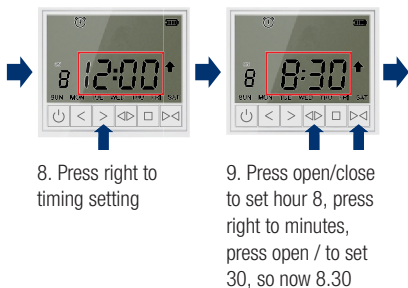

Set the timer point to up or down (up)

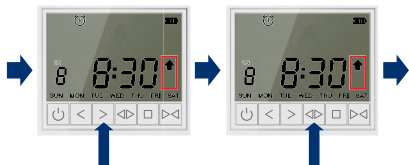

10. Press right to open/close setting

11. Press open/close to set it as open

**Note:** ▲ = open, ▼ = close

Set days of week (Monday to Friday)

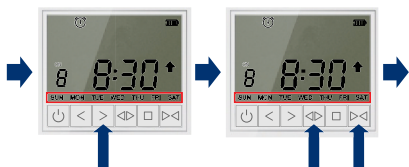

12. Press right to week setting

13. Press open/close to move week day, press stop to add/delete days

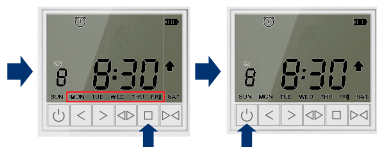

14. To set the weekly day from Monday to Friday

15. Press and hold the function button for 3s to save and exit from the window

### Note

If you want to assign a time point to more than one day follow steps 13 – 14, to choose the weekdays required.

If you do not require a particular day press right to ignore the day or press stop to delete it.

Time point setting now complete.

## Trouble shooting

Trouble	Reasons	Solution
The display is not completed show and not clear	Please check the power display	Please change battery re-set time/day (time points are stored permanently)
Poor remote sensitivity	Please check the installation ambient if there is metal things	Please change the installation position
No response after pressing button	1. Screen is locked 2. Please touch it in correct area	1. Please press function button 3s to unlock the screen 2. Please touch it in correct area

[www.silentgliss.co.uk](http://www.silentgliss.co.uk)

Silent Gliss Ltd.  
Pyramid Business Park  
Poorhole Lane, Broadstairs  
Kent CT10 2PT  
Great Britain

Tel: +44 (0) 1843 863571  
Fax: +44 (0) 1843 864503  
[info@silentgliss.co.uk](mailto:info@silentgliss.co.uk)

SGGB\_0816